



6-Port Industrial Unmanaged Gigabit Ethernet Switch

ST-IND0402TS Datasheet

Product Description

ST-IND0402TS is a 6-Port unmanaged Industrial Gigabit Ethernet switch that provides 4 Gigabit Rj45 ports and 2 Gigabit SFP slots. It adopts fanless heat dissipation circuit and redundant power circuit design, and the switch supports EMC industry level 4 protection performance, with corrugated high-strength aluminum profile shell, IP40 grade, low power consumption, earthquake-resistant Din-rail installation, -40°C-75°C Working temperature, which can performance well in harsh environment.

Product Appearance

	ST-IND0402TS	<ul style="list-style-type: none"> • Input voltage: DC: 12-24V • Working temperature: -40°C ~ +75°C • Shell: IP40 protection level, fanless design • Static electricity: 8KV-15KV • MTBF: 100000 hours
-----------------------------------------------------------------------------------	--------------	-----------------------------------------------------------------------------------------------------------------------------------------------------------------------------------------------------------------------------------------------------------

Product Performance

- Provide 4*10/100/1000M Self-adaptive Rj45 ports
- Provide 2*1000M SFP slots
- Support IEEE 802.3x full-duplex flow control and Backpressure half-duplex flow
- Each RJ45 port supports MDI/MDIX auto flip and wire-speed forwarding functions

Product Parameters

Model	ST-IND0402TS
Port description	4 x Electrical port (Rj45) 1000BASE-T 2 x Optical port (SFP) 1000BASE-X
Optical port characteristics	Interface type: SFP Speed: 1000Mbps Wavelength: Single-mode fiber: 1310nm/1550nm Multimode fiber: 850nm Core standard: Single mode: 8.3μm, 8.7μm, 9μm, 10μm Multimode: 50μm, 62.5μm, 100μm
Electrical port characteristics	Interface type: RJ45 Rate: 10/100/1000Mbps adaptive Duplex mode: full/half duplex Connection mode: MDI/MDIX automatic flip

Protocol standard	<p>IEEE802.3i 10 BASE-T</p> <p>IEEE802.3u 100 BASE-TX</p> <p>IEEE802.3ab 1000 BASE-T</p> <p>IEEE802.3z 1000 BASE-LX</p> <p>IEEE802.3x Flow Control</p> <p>IEEE802.3az EEE</p>
Exchange performance	<p>Backplane bandwidth: 12Gbps</p> <p>Packet forwarding rate: 8.92Mpps</p> <p>MAC address: 8K</p> <p>Packet buffer: 2Mbit</p> <p>Forwarding mode: Store and forward</p>
Power supply	<p>Input power: DC 12~24V (6PIN Phoenix terminal), 1*DC interface</p> <p>Power consumption: full load < 6W</p> <p>Dual power supply: support</p> <p>Redundant protection: support</p> <p>Reverse connection protection: support</p>
Mechanical structure	<p>Shell material: metal</p> <p>Protection level: IP40</p> <p>Size: 145*103*44mm (Excluding connector protruding part and DIN rail assembly size)</p> <p>Weight: 0.80Kg</p> <p>Installation method: DIN rail installation</p>
Surroundings	<p>Working temperature: -40°C~75°C</p> <p>Storage temperature: -40°C~85°C</p> <p>Relative humidity: 5%~95% RH (non-condensing)</p>
Industry Standard	<p>EMI: CE/FCC</p> <p>EMS: IEC61000-4-2 (ESD-static)</p> <p>IEC61000-4-3 (RS-radiation anti-interference)</p> <p>IEC61000-4-4 (EFT-fast burst)</p> <p>IEC61000-4-5 (Surge-lightning protection)</p> <p>IEC61000-4-6 (CS-conducted anti-interference)</p> <p>Machinery: IEC60068-2-6 (vibration)</p> <p>IEC60068-2-27 (Shock)</p> <p>IEC60068-2-32 (free fall)</p> <p>Industry: IEC61000-6-2</p> <p>Railway: EN50155, EN50121-4</p> <p>Transportation: NEMA TS-2</p>
Warranty	<p>Warranty period: 3 years</p>

Installation method

Before installation, confirm the operating environment of the equipment: power supply voltage, installation space, installation method, etc. Please carefully confirm the following installation requirements:

1. Check if there are cables and connectors required for installation
2. According to the reasonable configuration requirements, check whether the cable is in place (not more than 100m)
3. The product does not provide installation components, the user needs to prepare the components of the selected installation type: screws, nuts, tools, etc., to ensure reliable installation

Power requirements: 12-24V DC

Environmental requirements

Working temperature: -40 ~ 75°C

Storage temperature: -40 ~ 75°C

Relative humidity: 5% ~ 95% (no condensation)

Rail installation

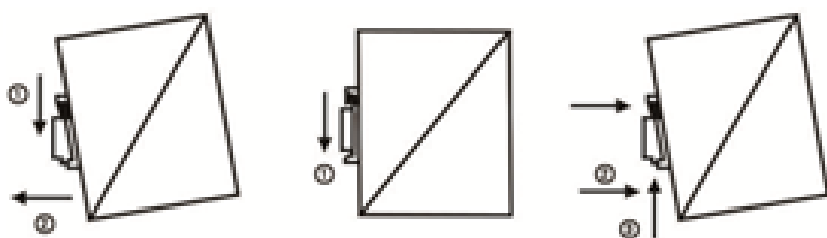

Note: All pictures are schematic diagrams, and the actual product is the main product

Order Information

ST-IND0402TS	4*10/100/1000M Self-adaptive RJ45 ports + 2*1000M SFP slots
--------------	-------------------------------------------------------------